



Zanzibar · Tanzania

ACCOMMODATION PRICE LIST

November 1st 2025 - October 31st 2027



Holidays



Scan the QR
Code for Our
Latest Price List



Welcome to Tanzania & Zanzibar

the land of
safaris, nature,
culture
and wildlife.



Company websites:

www.paradise-wilderness.com
www.hotelzanzibar.com
www.africa-safari.com

- Room rates are per person per night
- Single room rates on request
- Subject to availability

sales@paradise-wilderness.com

Rates Valid between:
November 1st 2025 – October 31st 2027

Explanations on taxes, fees and levies

Infrastructure tax¹ of US\$5 per person per day is payable to the Zanzibar government. The tax is to be collected by the hotel accommodation from all in-house guests on behalf of the Zanzibar Revenue Board (ZRB).

TDL² refers to a government tax called Tourism Development Levy. The hotel accommodation is obliged to collect this bed night levy on behalf of the Tanzania Revenue Authority (TRA).

Village fee³ refers to a village levy imposed by the village council in which, or near to where the hotel accommodation is located. This amount varies per location and is to be used by the village for support and development.

Remark To bring more simplicity and unity in the Tanzania mainland taxes for our lodges, we have combined TDL² and Village fee³ into a fixed amount of US\$2.50 per person per night..

WMA fees⁴ of in total US\$29.50 per person per night apply on overnights in hotel accommodations located in a Wildlife Management Area. It consists of a bed-night levy (also called 'concession fee') of US\$10+18% VAT and US\$15+18% VAT Wildlife Division/Conservation fee to MNRT. Vehicle fees also apply.

Gate fees⁵ apply on the road to Natron. There are 3 different gates in the area; usage of these gates sum up to a total of US\$35 per person per stay.

Ngorongoro Concession fee⁶ applies when you overnight in Ngorongoro Conservation Area. The fee is per person per night. 5 - < 15 years: US\$35.40 / Adult >15 years US\$70.80.

TANAPA Concession fee⁷ applies when you overnight in a TANAPA (Tanzanian National Parks Conservation Area.) The fee is per person per night. 5 <15 years: US\$35.40 / Adult >15 years US\$70.80.

Value Added Taxes (VAT) Our published accommodation rates are including 15% VAT in Zanzibar and 18% VAT in mainland Tanzania.

IMPORTANT UPDATE Zanzibar authorities have implemented a mandatory requirement for visitors to purchase a specific travel insurance designated by the government. For more details, please [click here](#).

Published info and rates (December 2024) are subject to changes in government taxes and village fee increases or levy changes.

Stay Informed:
Scan for the
Latest Tax,
Fee, and Levy
Updates



Zanzibar

06



About Zanzibar
The jewel of the Indian Ocean.

08



Reef & Beach Resort ****
Jambiani
South East Coast.

10



Paradise Beach Resort ****
Marumbi
North East Coast.

12



Zanzibar Bay Resort ****
Marumbi
North East Coast.

14



Dream of Zanzibar *****
Uroa
North East Coast.

16



Shaba Boutique Hotel ****
City centre
Stone Town.

18



Corals of Zanzibar Beach Resort ****
(Under construction)

20



Paradise Island ****
(Under construction)

22



Pemba Beach Resort
(Under construction)

24



Pemba Farm Estate
(Under construction)

26



Mkoani Guesthouse
(Under construction)

Tanzania

30



About Tanzania
All about wildlife.

32



Africa Safari Arusha
Safari capital of Tanzania.

34



Africa Safari Lake Natron
Lake Natron
Game Controlled Area.

36



Africa Safari Maasai Boma
Loliondo Game Controlled Area - Serengeti National Park.

38



Africa Safari Serengeti Kogatende
(Under construction)

40



Africa Safari Serengeti Ikoma
Ikona Game Controlled Area - Serengeti National Park.

42



Africa Safari Serengeti Kusini
Kusini Plains - South Serengeti National Park.

44



Africa Safari South Serengeti (Ndotu)
Lake Ndotu - Ngorongoro Conservation Area Ngorongoro Crater Serengeti National Park.

46



Africa Safari Ngorongoro Crater *(Under construction)*

48



Africa Safari Karatu
Karatu - North Tanzania Ngorongoro Crater - Lake Manyara National Park.

50



Africa Safari Escarpment Lake Manyara

52



Africa Safari Migombani Lake Mayara

54



Africa Safari Lake Manyara
Lake Manyara National Park - Tarangire National Park - Ngorongoro Crater.

56



Africa Safari Rift Valley
South West Lake Manyara - Lake Manyara National Park, Tarangire National Park.

58



Africa Safari Tarangire *(Under construction)*

60



Africa Safari Kilimanjaro Airport *(Under construction)*

62



Africa Safari Saadani
Saadani National Park *(Under construction)*

64

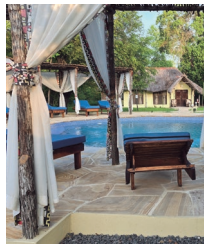

Africa Safari Selous
Selous Game Reserve - Nyerere National Park.

66



Africa Safari Nyerere
Selous Game Reserve - Nyerere National Park *(Under construction).*

68



Africa Safari Tagalala Hot Spring
Selous Game Reserve - Nyerere National Park *(Under construction)*

About Zanzibar

The island of Zanzibar is considered one of the jewels of the Indian Ocean.

In Zanzibar, nature and history are closely linked. You can visit Stone Town - the historic centre of Stone Town that is listed as a world heritage site under the protection of UNESCO. Or you can soak up the sun on one of the islands' pristine white beaches. Explore the fauna of the island with its unique Red Colobus monkeys, dive into the crystal-clear waters or use the island as a base for safaris into the stunning Tanzanian National Parks. No matter what you choose: Zanzibar is certainly your ideal holiday destination.

ACCOMMODATIONS

1. Reef & Beach Resort ****
2. Paradise Beach Resort ****
3. Zanzibar Bay Resort ****
4. Dream of Zanzibar *****
5. Shaba Boutique Hotel ****
6. Corals of Zanzibar *(opening soon)*
7. Paradise Island *(opening soon)*
8. Pemba Beach Resort *(opening soon)*
9. Pemba Farm Estate *(opening soon)*
10. Mkoani Guesthouse *(opening soon)*



6°09'50" S - 39°11'52" E | Area: 1,464 km²

USEFUL INFORMATION:

Electricity: 220V

Plug: English three-pin plug

Languages: Swahili and English

Country code: +255

Internet: Fiber and good mobile network

International Airport: Abeid Amani Karume International Airport, Stone Town

TOTAL SUN HOURS PER MONTH:

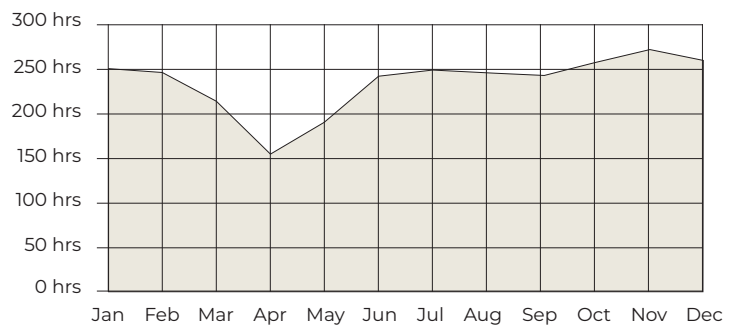

AVERAGE TEMPERATURES:

Month	Jan	Feb	Mar	Apr	May	Jun	Jul	Aug	Sep	Oct	Nov	Dec
Min (°C)	23	23	23	24	23	22	21	20	20	21	22	23
Max (°C)	32	33	32	30	29	29	29	29	30	31	31	31
Min (°F)	73	73	73	75	73	72	70	68	68	70	72	73
Max (°F)	90	91	90	86	84	84	84	84	86	88	88	88

Zanzibar
the jewel of the
Indian Ocean.



Reef & Beach Resort ****

Jambiani - South East Coast

Reef & Beach Resort is located between two villages named Jambiani and Makunduchi. Here you'll find more than 600 metres of seafront, multiple swimming pools, pool bars, a magical Jetty bar, and a 300-metre-long sun terrace where guests can relax on comfortable sunbeds while taking in breathtaking views of the ocean. Wander along the beautifully designed wooden bridge, through the resort's tropical mangrove forest, to one of the most beautiful stretches of coastline on the island.

Choose from a variety of accommodation options, ranging from charming thatched-roof bungalows to spacious suites, all with views of either the ocean, the large natural sandstone swimming pool, or the landscaped surroundings. Plus, for an added touch, indulge in our swim-up rooms, where you can enjoy direct access to the refreshing pool waters right from your patio. The Makuti Restaurant offers delectable, fresh cuisine and our talented chefs prepare a diverse and delicious buffet menu for breakfast, lunch, and dinner. Peponi, an open and breezy oceanfront restaurant offers a delightful selection of Italian favourite dishes for dinner, whilst Bahari will serve an international menu for lunch and transport you to the vibrant flavours of India for dinner. Relax with a refreshing beverage and a wood-fired pizza, whilst taking in the stunning views at Mango Beach Club. With six onsite bars, you'll have a wide selection of options where you can enjoy your preferred refreshment. Relax with a refreshing beverage and a wood-fired pizza, whilst taking in the stunning views at Mango Beach Club. With four onsite bars, you'll have a wide selection of options where you can enjoy your preferred refreshment.

The Spa and gym ensure your well-being, while the 24-hour reception, Guest Relations Office and Excursion Desk are at your service for enquiries, excursions, taxis, and last-minute safari adventures.

- ✓ PADI Dive Centre
- ✓ 24-hour front desk
- ✓ Information, Transfer, Safaris and Excursion desk
- ✓ Activities & Animation
- ✓ 300 metre Jetty with sun beds
- ✓ Pool table, ping-pong & other games
- ✓ Garden lounge areas
- ✓ Free Wi-Fi
- ✓ Swimming pools
- ✓ Complimentary use of beach towels and safety deposit box
- ✓ Medical Centre on Site



Highlights



Authentic African-themed resort



Directly on a white sand beach



Jetty Lounge Bar, stretching out over the Indian Ocean



Coral Reef within walking distance during low tide



Unique sun deck and swimming platform



Great variety of excursions and activities



Multiple swimming pools



Variety of accommodation options



Choice of restaurants & bars



Wi-Fi throughout the resort and on the beach

✓ **FAQ**

Our staff speak multiple languages
 ATM is available in Paje Village
 (15 minutes drive)
 Check-in: 14.00h / Check-out: 11.00h
 Complimentary use of beach towels, safety deposit box, and Wi-Fi
 Stone Town and the airport only
 64km away
 Cash USD, TZS, EURO and credit card payments are welcome



01/11/2025 - 31/10/2027 based on All-Inclusive meal plan

Rates per night, per person and based on 2-person sharing, All-Inclusive meal plan

REEF AND BEACH RESORT **** Shungi - South East coast Zanzibar	1 NOVEMBER - 23 DECEMBER 16 MAY - 15 JUNE 1 SEPTEMBER - 31 OCTOBER	24 DECEMBER - 14 MARCH 16 JUNE - 31 AUGUST	15 MARCH - 15 MAY
ROOM TYPE:	Meal plan: All-inclusive		
Standard Room	\$115.00	\$127.00	\$81.00
Suite Room Ocean View	\$141.00	\$155.00	\$99.00
Family Room Ocean View (min 4 guests)	\$141.00	\$155.00	\$99.00
Suite Room Mangrove/Pool View	\$120.00	\$132.00	\$84.00
Family Room Mangrove/Pool View (min 4 guests)	\$120.00	\$132.00	\$84.00
Garden Bungalow	\$146.00	\$161.00	\$102.00
Ocean Bungalow	\$152.00	\$167.00	\$106.00
Garden Room	\$162.00	\$178.00	\$113.00
Villa (Honeymoon)	\$183.00	\$201.00	\$128.00
Ocean Front Room	\$183.00	\$201.00	\$128.00
Garden Swim-up (Adults only)	\$194.00	\$213.00	\$136.00
Ocean Front Swim-up (Adults only)	\$215.00	\$237.00	\$151.00
Children 0 – 1.99 years (Sharing Room)	-	-	-
Children 1.99 – 11.99 years (Sharing Room)	\$39.00	\$43.00	\$27.00
Adults > 12 years (Sharing Room)	\$83.00	\$91.00	\$58.00

Infrastructure tax of \$5 per person per night is not included and must be paid upon check-in. All rooms except the Family Rooms and the Villa can be used for single occupancy. Single room rate on request, contact us for detailed prices. Prices may be adjusted due to unforeseen changes and/or new government levies. For reservations including the night of December 31st, a minimum stay of 5 nights is required.

ROOM TYPE:	Num. of rooms	Guests per rooms	Bedroom size (sqm)	Bathroom size (sqm)	Balcony size (sqm)	Total room size (sqm)	King size bed	Sofa/Single bed	Sofa bed	Bunk bed	Add. single bed (on request)	Max. guests per room
Standard Room	8	2	20	15	10	45	1					2
Suite Room Ocean View	20	2	25	6	10	41	1				1	3
Family Room Ocean View (min 4 Guests)	4	2+1+1+1	25+10	6	11	52	2	1		1		5
Suite Room Mangrove/Pool View	81	2	24	15	10	49	1				1	3
Family Room Mangrove/Pool View (min 4 guests)	3	2+1+1+1	48	20	10	78	2	1		1	1	6
Garden Bungalow	4	2	25	5	9	39	1				1	3
Ocean Bungalow	10	2	25	5	9	39	1				1	3
Villa (Honeymoon)	1	2+2+1	20+22	14	20	76	2	1				5
Garden Room	15	2+2	34	8	9	51	1		1			4
Ocean Front Room	41	2+2	34	8	9	51	1		1			4
Garden Swim-up	12	2+2	34	8	9	51	1		1			4
Ocean Swim-up	23	2+2	34	8	9	51	1		1			4

Guests per room: 2 = Double | 1 = Single

Paradise Beach Resort ****

Marumbi - North East Coast

Paradise Beach Resort is a 4-star resort offering an impressive variety of room categories with different sizes and bedding configurations to suit all travellers, including groups. The resort is located directly by the ocean, near the village of Marumbi, Uroa, on the east coast of Zanzibar.

With a Kids Club, an extensive playground with slides, swings and a trampoline, a children's swimming pool and a kids buffet, this resort is the perfect place to spend a fun holiday with your family. Additionally, the resort offers a host of facilities for guests to enjoy, including a Spa & Wellness centre, gym, large swimming pool, an extended jetty furnished with sun beds and a jetty bar, and a dive centre for underwater enthusiasts. The Excursion Desk provides a range of tours across the picturesque island of Zanzibar. For those seeking unforgettable adventures beyond the shores of Zanzibar, we also offer safari trips to Tanzania's mainland wildlife areas, including Selous and Mikumi.

- ✔ PADI Dive Centre
- ✔ 24-hour front desk
- ✔ Information, Transfer, Safaris and Excursion desk
- ✔ Activities & Animation
- ✔ Bike and kayak rental
- ✔ Pool table, ping-pong & other games
- ✔ Garden lounge areas
- ✔ Free Wi-Fi
- ✔ Huge swimming pool
- ✔ Complimentary use of beach towels and safety deposit box
- ✔ Doctor on Site



Highlights



Authentic African-themed resort



Directly on the white sand beach



Jetty Lounge Bar, stretching out over the Indian Ocean



Unique sun deck and swimming platform



Perfect accommodation for couples, friends or families



Daily animation program



Huge swimming pool and children's pool



Choice of restaurants & bars



Wi-Fi throughout the resort and on the beach



Great variety of excursions and activities



FAQ

Our staff speak multiple languages

ATM is available in Dunga Village
(15 minutes drive)

Check-in: 14.00h / Check-out: 11.00h

Complimentary use of beach towels,
safety deposit box and Wi-Fi

Stone Town and the airport are only
35km away

Cash USD, TZS, EURO and credit card
payments are welcome



01/11/2025 - 31/10/2027 based on All-Inclusive meal plan

Rates per night, per person and based on 2-person sharing, All-Inclusive meal plan

PARADISE BEACH RESORT **** Marumbi - North East coast Zanzibar	1 NOVEMBER - 23 DECEMBER 16 MAY - 15 JUNE 1 SEPTEMBER - 31 OCTOBER	24 DECEMBER - 14 MARCH 16 JUNE - 31 AUGUST	15 MARCH - 15 MAY
ROOM TYPE:	Meal plan: All-inclusive		
Standard Room	\$112.00	\$123.00	\$78.00
Suite Room	\$123.00	\$135.00	\$86.00
Luxury Room (with separate bedroom)	\$126.00	\$139.00	\$88.00
Premium Room (with separate bedroom)	\$137.00	\$151.00	\$96.00
Family Room (min. 4 guests) (with separate bedroom)	\$143.00	\$157.00	\$100.00
Swim-up Room	\$135.00	\$149.00	\$94.00
Bungalow (Honeymoon)	\$155.00	\$171.00	\$109.00
Children 0 – 1.99 years (Sharing Room)	-	-	-
Children 1.99 – 11.99 years (Sharing Room)	\$39.00	\$43.00	\$27.00
Adults > 12 years (Sharing Room)	\$81.00	\$91.00	\$58.00

Infrastructure tax of \$5 per person per night is not included and must be paid upon check-in. All rooms except the Family Room can be used for single occupancy. Single room rate on request, contact us for detailed prices. Prices may be adjusted due to unforeseen changes and/or new government levies. For reservations including the night of December 31st, a minimum stay of 5 nights is required.

ROOM TYPE:	Num. of rooms	Guests per rooms	Bedroom size (sqm)	Bathroom size (sqm)	Balcony size (sqm)	Total room size (sqm)	King size bed	Sofa/ Single bed	Bunk bed	Add. single bed (on request)	Max. guests per room
Standard Room	48	2	20	5		25	1				2
	2	2+1+1	27	5	2	34	1		1		4
Suite Room	28	2+1	35	6	10	51	1	1		1	4
Luxury Room	12	2+1	30	6	12	48	1	1			3
Premium Room	16	2+1+1	35	8	12	55	1	2		1	5
Family Room (min. 4 guests)	2	2+1+1+1+1	70	10	16	96	1		2	2	8
Swim-up Room	22	2	20	5		25	1				2
Bungalow	2	2	30	11	30	71	1				2

New Room Additions:

- From June 1st, 2026: 15 standard rooms + 15 Luxury rooms

Guests per room: 2 = Double | 1 = Single

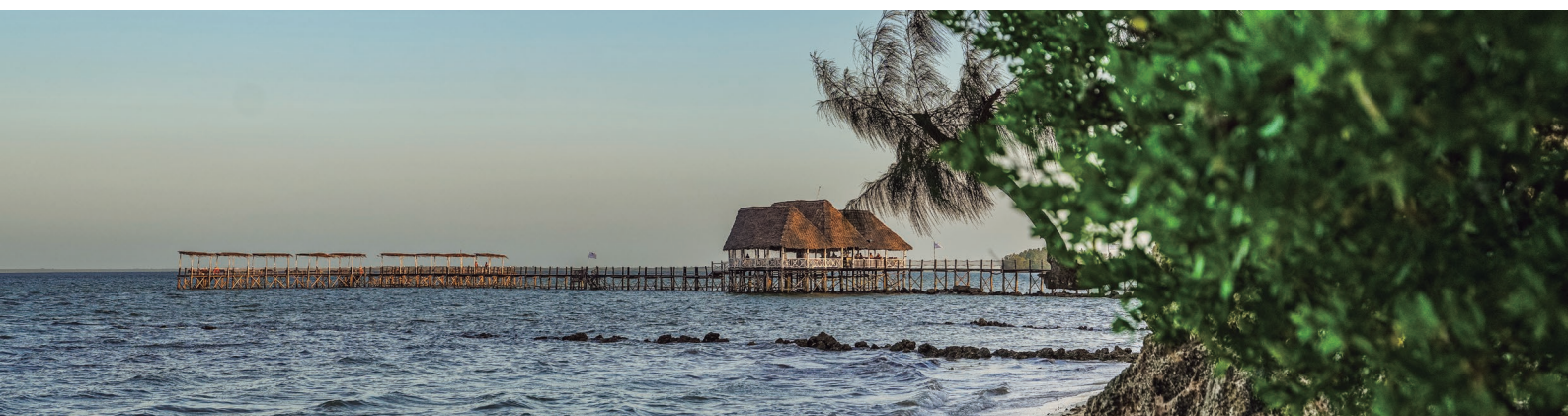

Zanzibar Bay Resort ****

Marumbi - North East Coast

Situated adjacent to Paradise Beach Resort, Zanzibar Bay Resort offers 104 rooms within a serene and relaxed seaside setting. The spacious rooms feature rustic, authentic wooden furniture, an ensuite bathroom with a shower, and coffee and tea-making facilities. This beachfront resort boasts two large infinity pools: one with a tropical island pool bar and the other designed for diving courses. Additionally, there's the enchanting Jetty, equipped with a bar, sunbeds, and a swimming platform extending over the Indian Ocean.

Zanzibar Bay Resort is situated next to Paradise Beach Resort, and guests can use the facilities of both resorts. Between Paradise Beach Resort and Zanzibar Bay Resort lies a buffet restaurant, two à la carte restaurants, four bars, a Spa & Wellness Centre, a gym, and a Kids Club. For various meetings, gatherings, and events, the boardroom comfortably accommodates up to 12 individuals, while the larger venue provides space for up to 126 attendees, making it ideal for conferences, weddings, and other functions.

- ✓ PADI Dive Centre
- ✓ 24-hour front desk
- ✓ Information, Transfer, Safaris and Excursion desk
- ✓ Activities & Animation
- ✓ Bike and kayak rental
- ✓ Pool table, ping-pong & other games
- ✓ Garden lounge areas
- ✓ Free Wi-Fi
- ✓ Swimming pools
- ✓ Meeting and conference facilities
- ✓ Complimentary use of beach towels and safety deposit box
- ✓ Doctor on Site

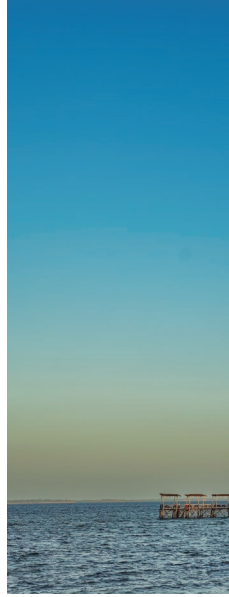

Highlights



Authentic African-themed resort



Low tide white sand beach



Jetty Lounge Bar, stretching out over the Indian Ocean



Unique sun deck and swimming platform



Perfect accommodation for couples, friends or families



Great variety of excursions and activities



Two swimming pools



Second swimming pool, suitable for diving sessions



Choice of restaurants & bars



Wi-Fi throughout the resort and on the beach



FAQ

Our staff speak multiple languages

ATM is available in Dunga Village (15 minutes drive)

Check-in: 14.00h / Check-out: 11.00h

Complimentary use of beach towels, safety deposit box and Wi-Fi

Stone Town and the airport are only 35km away

Cash USD, TZS, EURO and credit card payments are welcome



01/11/2025 - 31/10/2027 based on All-Inclusive meal plan

Rates per night, per person and based on 2-person sharing, All-Inclusive meal plan

ZANZIBAR BAY RESORT **** Marumbi - North East coast Zanzibar	1 NOVEMBER - 23 DECEMBER 16 MAY - 15 JUNE 1 SEPTEMBER - 31 OCTOBER	24 DECEMBER - 14 MARCH 16 JUNE - 31 AUGUST	15 MARCH - 15 MAY
ROOM TYPE:	Meal plan: All-inclusive		
Standard Room	\$115.00	\$127.00	\$81.00
Luxury Room	\$137.00	\$151.00	\$96.00
Premium Room	\$160.00	\$176.00	\$112.00
Premium Plus Room	\$210.00	\$231.00	\$147.00
Children 0 – 1.99 years (Sharing Room)	-	-	-
Children 1.99 – 11.99 years (Sharing Room)	\$39.00	\$43.00	\$27.00
Adults > 12 years (Sharing Room)	\$83.00	\$91.00	\$58.00

Infrastructure tax of \$5 per person per night is not included and must be paid upon check-in. All rooms can be used for single occupancy. Single room rate on request, contact us for detailed prices. Prices may be adjusted due to unforeseen changes and/or new government levies. For reservations including the night of December 31st, a minimum stay of 5 nights is required.

ROOM TYPE:	Num. of rooms	Guests per rooms	Bedroom size (sqm)	Bathroom size (sqm)	Balcony size (sqm)	Total room size (sqm)	King size bed	Add. single bed (on request)	Max.guests per room
Standard Room	22	2	26	8	10	44	1	1	3
Luxury Room	64	2	30	9	12	51	1	1	3
Premium Room	16	2	36	10	14	60	1	1	3
Premium Plus Room	2	2	60	19	16	95	1	1	3

Guests per room: 2 = Double | 1 = Single



Dream of Zanzibar *****

Uroa - North East Coast

Dream of Zanzibar is a boutique-style luxury resort, perfectly positioned on the endless white sands of Uroa along Zanzibar's east coast, only a 40 km drive from Stone Town and a 45 km drive from the airport. Relaxation, wholesome dining, tropical cocktails, and fantastic rooms are the keywords here.

Our staff will pamper you with 5-star service, ensuring your every need is met during your stay. The only thing you need to do is to choose your favourite room type and we'll do the rest! We make it easy; everything is included! Think meals, drinks and cocktails, appetisers, and several other surprising services. We call it a Premium All-inclusive! A perfect after-your-safari beach holiday or a standalone lazy relaxing beach holiday, our Zanzibari staff will make it an unforgettable stay.

Amenities include a Spa & Wellness Centre with a gym, massage rooms, hammam, and sauna. The restaurant serves delectable dishes created from the freshest of ingredients while the beach bar offers a variety of refreshments served alongside tasty bites. The resort also features a rooftop Shisha Lounge, a boutique showcasing exquisite gifts and souvenirs, and a hair salon. Additionally, a 24-hour reception and an Excursions desk are ready to assist in any way.

- ✔ PADI dive centre
- ✔ 24-hour front desk
- ✔ Information, Transfer, Safaris and Excursion desk
- ✔ "Blue Waves" restaurant
- ✔ "Seascapes" bar, bites and cocktails
- ✔ Rooftop Shisha lounge
- ✔ Free Wi-Fi
- ✔ 24-hour room service
- ✔ Premium All-inclusive meal plan
- ✔ Swimming pool
- ✔ Complimentary use of beach towels and safety deposit box



Highlights



Built in 2023



5 star luxury



Directly on the white sandy beach



Ocean-facing restaurant



Premium All-inclusive meal plan



Boutique beach resort



Perfect accommodation for couples and friends



Variety of room categories to choose from



Large swimming pool



Wi-Fi in the entire Resort and on the beach



FAQ

Our staff speak multiple languages

ATM is available in Kiwengwa

Check-in: 14.00h / Check-out: 11.00h

Complimentary use of beach towels, safety deposit box and Wi-Fi

Stone Town and airport only 40km

Cash USD, TZS, EURO and credit card payments are welcome



01/11/2025 - 31/10/2027 based on Premium All-inclusive meal plan

Rates per night, per person and based on 2-person sharing, Premium All-Inclusive meal plan

DREAM OF ZANZIBAR ***** Uroa - Zanzibar	1 NOVEMBER - 23 DECEMBER 16 MAY - 15 JUNE 1 SEPTEMBER - 31 OCTOBER	24 DECEMBER - 14 MARCH 16 JUNE - 31 AUGUST	15 MARCH - 15 MAY
	Meal plan: Premium All-Inclusive		
Garden Suite	\$256.00	\$282.00	\$179.00
Ocean Suite	\$279.00	\$307.00	\$195.00
Deluxe Ocean Suite	\$297.00	\$327.00	\$208.00
Ocean Premium Suite	\$315.00	\$347.00	\$221.00
Grand Ocean Suite	\$397.00	\$437.00	\$278.00
Penthouse Ocean Suite	\$415.00	\$457.00	\$291.00
Children 0 – 1.99 years (Sharing Room)	-	-	-
Children 1.99 – 11.99 years (Sharing Room)	\$102.00	\$112.00	\$71.00
Adults > 12 years (Sharing Room)	\$179.00	\$197.00	\$125.00

Infrastructure tax of \$5 per person per night is not included and must be paid upon check-in. Grand Ocean Suites and Penthouse Ocean Suites can't be used for single occupancy. Prices may be adjusted due to unforeseen changes and/or new government levies. For reservations including the night of December 31st, a minimum stay of 5 nights is required.

ROOM TYPE:	Num. of rooms	Guests per rooms	Bedroom 1 size (sqm)	Bedroom 2 size (sqm)	Bathroom 1 size (sqm)	Bathroom 2 size (sqm)	Balcony size (sqm)	Total room size (sqm)	King size bed	Single bed	Sofa bed available (double)	Add. single bed (on request)	Max. guests per room
Grand Ocean Suite	2	2+1+1	76		10	5	25	116	1	2	1	1	6
Penthouse Ocean Suite	1	2+1+1	38	36	12	5	25	116	1	2	1	1	6
Premium Ocean Suite	2	2	67		10		26	103	1		1	1	4
Ocean Suite	8	2	36		10		13	59	1		1	1	4
Deluxe Ocean Suite	2	2+1+1	40	17	10		11	78	1	2	1	1	6
Garden Suite	21	2	40		15		15/9	70/64	1		1	1	4

Guests per room: 2 = Double | 1 = Single



Shaba Boutique Hotel ****

Stone Town

Nestled in the heart of Stone Town, Shaba Boutique Hotel offers a charming bed and breakfast experience. Situated just a 2-minute walk from the beach and ferry terminal and a short 15-minute drive from the airport, its location is both convenient and captivating. The surrounding area boasts authentic Stone Town ambiance, with cobbled alleyways, bustling markets, and cozy cafes by the shoreline. A variety of restaurants and bars with stunning ocean views are within easy reach. Shaba Boutique Hotel serves as an ideal base for exploring the city's culture and history, while also providing easy access to excursions such as Prison Island and the Spice Farms. Whether arriving in Zanzibar or departing from the island, Shaba Boutique Hotel offers a comfortable and memorable stay amidst the timeless allure of Stone Town.

- ✔ Bed & Breakfast
- ✔ Three different room categories
- ✔ Located in the heart of Stone Town
- ✔ Authentic traders house
- ✔ Close to all the main attractions of Stone Town
- ✔ Free Wi-Fi
- ✔ Complimentary use of safety deposit box

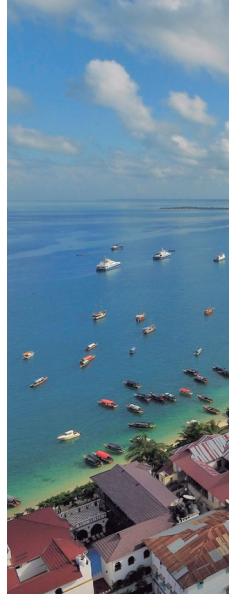

Highlights



Swahili Style Boutique Hotel



A cultural experience



Beautiful and characteristic building



In the heart of the old centre of Stone Town



Close to the airport and ferry port



Delicious Swahili/ Intercontinental breakfast



Many international restaurants in the vicinity



Free Wi-Fi



Only 450 metres from the ocean front



Close to all attractions, shopping streets and markets



FAQ

Our staff speak multiple languages

ATM is available (200 metres from the hotel)

Check-in: 14.00h / Check-out: 11.00h

Late-night doorman

10 kms from the airport

450 metres from the ocean front

Cash USD, TZS, EURO and credit card payments are welcome



01/11/2025 - 31/10/2027 based on Bed & Breakfast meal plan

Rates per night, per person and based on 2-person sharing, Bed & Breakfast meal plan

SHABA BOUTIQUE HOTEL **** Stone Town - Zanzibar	1 NOVEMBER - 23 DECEMBER 16 MAY - 15 JUNE 1 SEPTEMBER - 31 OCTOBER	24 DECEMBER - 14 MARCH 16 JUNE - 31 AUGUST	15 MARCH - 15 MAY
ROOM TYPE:	Meal plan: Bed & Breakfast		
Standard Room	\$53.00	\$58.00	\$37.00
Deluxe Room	\$58.00	\$64.00	\$41.00
Suite Room	\$68.00	\$75.00	\$48.00
Children 0 – 1.99 years (Sharing Room)	-	-	-
Children 1.99 – 11.99 years (Sharing Room)	\$21.00	\$23.00	\$15.00
Adults > 12 years (Sharing Room)	\$37.00	\$41.00	\$26.00

Infrastructure tax of \$5 per person per night is not included and must be paid upon check-in. All rooms can be used for single occupancy. Single room rate on request, contact us for detailed prices. Prices may be adjusted due to unforeseen changes and/or new government levies. For reservations including the night of December 31st, a minimum stay of 3 nights is required.

ROOM TYPE:	Room number	Floor	Guests per rooms	Bedroom size (sqm)	Second Bedroom size (sqm)	Bathroom size (sqm)	Balcony size (sqm)	Total room size (sqm)	Maximum guests per room
Standard Room	1	G	2	14		1.5		15.5	2
Standard Room	2	G	4	15	10	6		31	4
Suite 3 Guests	3	G	3	17.5	10	3.5		31	3
Deluxe Room	4	1st	2	10.5		4.5		15	2
Standard Room	5	1st	2	6		1.5		7.5	2
Standard Room	6	1st	2	7.5		1.5		9	2
Suite 4 Guests	7	1st	4	14.5	14	4		32.5	4
Deluxe Room	8	2nd	2	9.5		2	4.5	16	2
Deluxe Room	9	2nd	2	12		14	4.5	30.5	2
Deluxe Room	10	2nd	2	14		7.5		21.5	2
Standard Room	11	2nd	2	8.5		2.5	4	15	2
Standard Room	12	2nd	2	6		1.5	3.5	11	2
Suite 2 Guests	14	2nd	2	13		2.5	5.5	21	2

G= Ground Floor 1st= First floor 2nd= Second floor

Guests per room: 2 = Double, 1 = Single | For all rooms, guests have to use 1 or more stair case(s)



Corals of Zanzibar *****

Opening
soon





Paradise Island *****

Opening
soon





Pemba Beach Resort

Opening
soon





Pemba Farm Estate

Opening
soon





Mkoani Guesthouse

Opening
soon







Welcome to Africa Safari



About Tanzania

We welcome you to explore the beauty and culture of stunning Tanzania.

This beautiful country is a natural wonderland like no other in the world. Tanzania is home to Kilimanjaro, the highest mountain on the continent. It is a safari makers dreamland where the animals roam wild and free and just an island away, the exotic oasis of white sandy beaches and magical sunsets of Zanzibar awaits.

The sensations of Africa cannot be explained, they can only be experienced.

ACCOMMODATIONS

1. Africa Safari Arusha
2. Africa Safari Lake Natron
3. Africa Safari Maasai Boma
4. Africa Safari Serengeti Kogatende (*Opening soon*)
5. Africa Safari Serengeti Ikoma
6. Africa Safari Serengeti Kusini
7. Africa Safari South Serengeti
8. Africa Safari Ngorongoro Crater (*Opening soon*)
9. Africa Safari Karatu
10. Africa Safari Escarpment Lake Manyara
11. Africa Safari Migombani Lake Mayara
12. Africa Safari Lake Manyara
13. Africa Safari Rift Valley
14. Africa Safari Tarangire (*Opening soon*)
15. Africa Safari Kilimanjaro Airport (*Opening soon*)
16. Africa Safari Saadani
17. Africa Safari Selous
18. Africa Safari Nyerere
19. Africa Safari Tagalala Hotsprings (*Opening soon*)

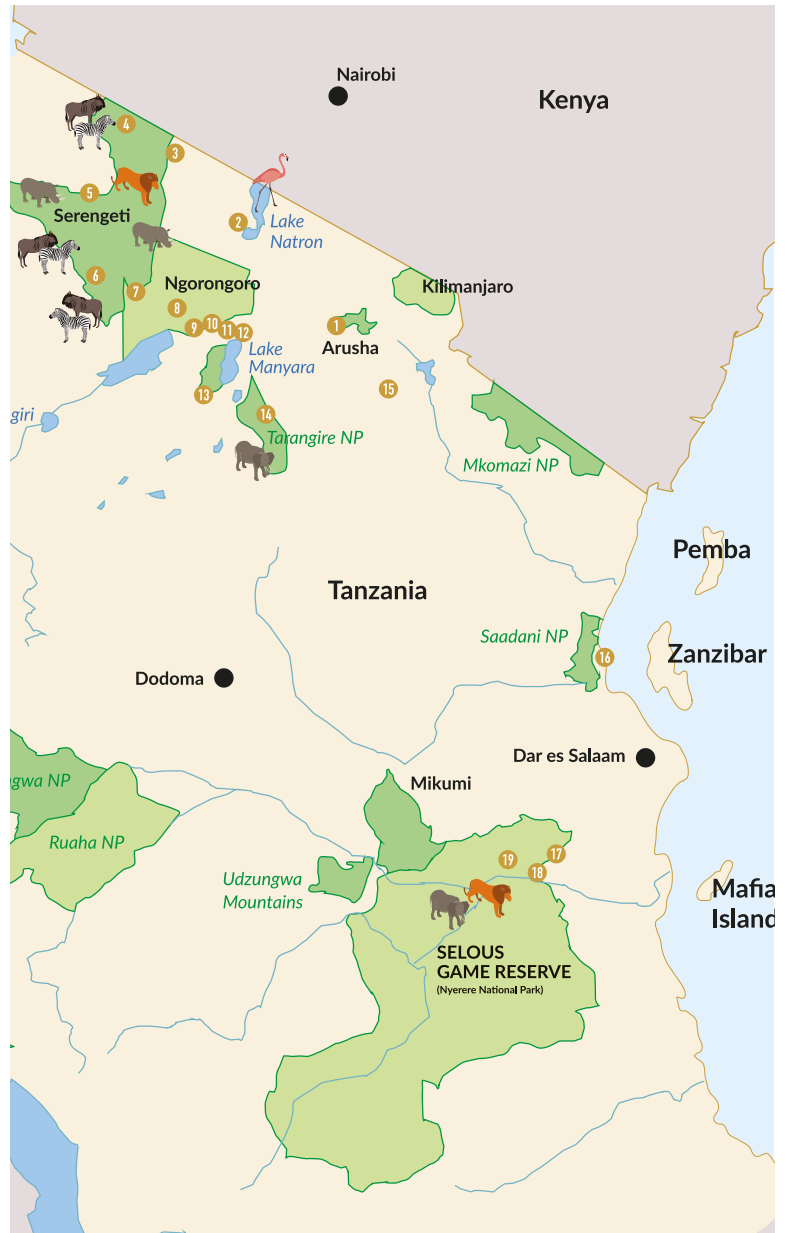

PICTURE-PERFECT BIG FIVE!

Traverse open roads on the lookout for elephant, rhino, buffalo, lion and leopard and uncover the reasons why Ngorongoro Crater is referred to as the 8th Wonder of the world.

THE GREAT MIGRATION IN TANZANIA

The annual “Wildebeest Migration,” is undoubtedly one of the most monumental natural spectacles in the world! Television does no justice to the migration of the magnificence of the wildebeest species and a live experience of this exhibition of nature from one of our safari accommodations is a must-do on your ‘bucket list’.

NO NEED TO TRAVEL THE SAME ROAD TWICE!

Paradise & Wilderness offers unlimited possibilities, especially in the composition of your itinerary. Most organisations follow the standard roads, but thanks to the perfect location of our accommodations, we can go off the beaten track and show you more of Tanzania’s beauty.

HOLIDAY EXPERIENCES YOU CAN RELY ON WITH PARADISE & WILDERNESS

Creating culture-rich and authentic holiday’s allowing people to discover the wonders and diversity of Africa and her people. Promoting responsible travel, TATO accredited with membership number FM/2016/000312.



Relaxing in African style



Africa Safari Arusha

Sakina, Arusha - North Tanzania Arusha National Park

Africa Safari Arusha is an intimate lodge set in the village of Sakina, just outside Arusha's city centre. The property accommodation consists of 9 Standard rooms and 8 Luxury rooms, surrounded by lush green gardens, a swimming pool with sun loungers and an open-air restaurant with a fireplace for the colder evenings. The unique tree bar is the perfect spot to enjoy a pre or post-dinner drink.

Mount Meru is perfectly positioned as the lodge's backdrop while views from the balconies span beyond the bright city lights of Arusha to the mountainous countryside. As you travel to Africa Safari Arusha on an unpaved road through the Ngateu Hills, there is no mistaking the very real sense of calm and culture.

The Standard rooms are in a building with 4 rooms per floor. The rooms are located along an open corridor that runs the length of the building. The Luxury rooms are in 4 stand-alone circular buildings with two floors; each floor is a room. The Standard Family room is an open-plan room, furnished with a double bed and two sets of bunk beds, accommodating up to six guests in a spacious environment.

- ✓ Lodge style hotel
- ✓ 15 minutes drive away from Arusha Airport & 1,5 hours drive from the Kilimanjaro Airport
- ✓ 2 hours drive to Tarangire NP and Lake Manyara NP
- ✓ Open year-round
- ✓ Perfect location in Arusha
- ✓ Swimming pool
- ✓ Unique views of Mount Meru
- ✓ Perfect place to relax before or after your safari
- ✓ Free Wi-Fi in restaurant and bar
- ✓ Complimentary use of pool towels and safety deposit box



Highlights



Close to Arusha airport



Swimming pool



Lush, manicured gardens



Perfect start or end point for your safari



Easy access to northern safari circuit



Great variety of activities



Free Wi-Fi available



Quiet and friendly area



Lodge style hotel



Relaxing atmosphere



FAQ

Our staff speak multiple languages

ATM available in Arusha. USD, Euro, Shillings & credit cards are welcome

Is it safe? Yes! The lodge has 24-hour security

When is the best time to go? All year round! Arusha has an average daytime temperature of 30°C

Check-in: 14.00h / Check-out: 11.00h

Solar heated water and electricity

Plug type: UK (type G)



01/11/2025 - 31/10/2027 based on Full Board meal plan

Rates per night, per person and based on 2 person sharing, Full Board meal plan

AFRICA SAFARI ARUSHA Sakina - Arusha district - North Tanzania		2025 - 2027
ROOM TYPE:	Meal plan: Full Board	
Standard Room	\$75.00	
Luxury Room	\$95.00	
Standard Family Room	\$75.00	
Children 0 – 1.99 years (Sharing Room)	-	
Children 1.99 – 11.99 years (Sharing Room)	\$40.00	
Adults > 12 years (Sharing Room)	\$65.00	

Meal plan change rates

Meal plan change for adults	Half Board -/-\$15.00	Bed & Breakfast -/-\$35.00
Meal plan change for children	Half Board -/-\$10.00	Bed & Breakfast -/-\$20.00

TDL² fee of US\$1.50 per person per night is not included and must be paid upon check-in.
Prices may be adjusted due to unforeseen changes and/or new government levies.
All rooms can be used for single occupancy.
Single room rate on request, contact us for detailed prices.

ROOM TYPE:	Num. of rooms	Guests per rooms	Bedroom size (sqm)	Bathroom size (sqm)	Total room size (sqm)	King size bed	Sofa/ Single bed	Bunk bed	Max. guests per room
Standard Room	6	2	18	6	24	1			2
	2	1+1	18	6	24		2		2
Luxury Room	8	2+1	23	8	31	1	1		3
Standard Family Room	6	2+1+1+1	50	10	60	1		2	6

Guests per room: 2 = Double | 1 = Single



Africa Safari Lake Natron

Engaresero - North Tanzania
Lake Natron Game Controlled Area

Africa Safari Lake Natron, situated on the edge of Lake Natron, is a luxury safari lodge offering easy access to the Northern Circuit national parks and reserves. Here you will find a dramatic lava desert terrain, together with a high alkaline lake in a depression created by the Rift Valley.

The Safari tents are simple and offer the same beautiful views of the mineral-rich 'soda' lake that sometimes turns a mesmerising pinkish-red. Safari Comfort rooms are large and comfortable, with air-conditioning, brick walls, a concrete floor and a permanent ensuite bathroom. The air-conditioned Luxury Glamping tents are built on a raised wooden deck and feature a beautiful rustic wooden interior. The swimming pool offers a beautiful view of the neighbouring Mount Ol Doinyo Lengai, a still active, unique and intriguing volcano and is an ideal spot for relaxing, sunbathing and taking in the magnificent scenery.

NEW
 All rooms have air-conditioning

- ✓ Breathtaking landscapes
- ✓ Perfect place to stay between Lake Manyara and Serengeti
- ✓ Adjacent to Ol Doinyo Lengai and Lake Natron
- ✓ Swimming pool
- ✓ An excellent choice for birders
- ✓ 24-hrs security
- ✓ Complimentary use of pool towels, safety deposit box and Wi-Fi



Highlights



Amazing scenery & spectacular wildlife



Activities with CBO Maasai guide



View over Lake Natron and Ol Doinyo Lengai



A choice of Glamping or Bungalow accommodation



Visit the Ngare Sero Waterfall



Restaurant with a great view



Wi-Fi by satellite



Only 0,2 kms from the main road



Air-conditioned accommodation



Swimming pool



FAQ

Our staff speak multiple languages

ATM not available. USD, Euro, Shillings & credit cards are welcome

Is it safe? Yes! The lodge is protected by the Maasai tribe

When is the best time to go? All year round! Lake Natron has an average daytime temperature of 30°C

Check-in: 14.00h / Check-out: 11.00h

Solar heated water and electricity

Plug type: UK (type G)



01/11/2025 - 31/10/2027 based on Full Board meal plan

Rates per night, per person and based on 2 person sharing, Full Board meal plan

AFRICA SAFARI LAKE NATRON Lake Manyara - Mto wa Mbu - North Tanzania	1 NOVEMBER - 14 MARCH 16 MAY - 31 OCTOBER	15 MARCH - 15 MAY
ROOM TYPE:	Meal plan: Full Board	
Safari Comfort Bungalow / Air-conditioned	\$152.00	\$106.00
Safari Luxury Glamping / Air-conditioned	\$191.00	\$134.00
Safari Tent	\$99.00	\$69.00
Children 0 – 1.99 years (Sharing Room)	-	-
Children 1.99 – 11.99 years (Sharing Room)	\$59.00	\$41.00
Adults > 12 years (Sharing Room)	\$107.00	\$75.00

Meal plan change rates

	HIGH SEASON		LOW SEASON	
	Meal plan change for adults	Half Board -/- \$19.00	Bed & Breakfast -/- \$44.00	Half Board -/- \$13.00
Meal plan change for children	Half Board -/- \$9.00	Bed & Breakfast -/- \$22.00	Half Board -/- \$6.00	Bed & Breakfast -/- \$15.00

TDL² and Village fee³ of US\$2.50 per person per night are not included and must be paid upon check-in.
WMA fee⁴ for Tanzania Wildlife Authority is not included and agents must submit these fees electronically online, while for private visitors, Africa Safari Lake Natron can assist.
Gate fees⁵ apply on the road to Natron.
Prices may be adjusted due to unforeseen changes and/or new government levies.
All rooms can be used for single occupancy.
Single room rate on request, contact us for detailed prices.

TAWA's WMA fee, per person per night

	NON-CITIZEN & RESIDENTS (USD)	TANZANIAN CITIZEN (TANZANIAN SHILLINGS)
Aged 18 years and Above	\$29.50	TSH8.260
Aged 5 - 17.99 years	\$23.60	TSH7.080
Aged below 5 years	\$0.00	TSH0

TAWA park fees are based on publication 2022

ROOM TYPE:	Num. of rooms	Guests per rooms	Bedroom size (sqm)	Bathroom size (sqm)	Balcony size (sqm)	Total room size (sqm)	King size bed	Sofa/Single bed	Bunk bed	Add. single bed (on request)	Max. guests per room
Safari Comfort Bungalow / Air-conditioned	10	2+1	12	9	16	37	1	1		1	4
Safari Luxury Glamping / Air-conditioned	5	2+1+1+1+1	12+12	5	15	75	1		2		6
	2	2	40	8	5	53	1				2
	2	2+1+1	60	11	12	83	1	2			4
Safari Tent	5	1+1									2

Guests per room: 2 = Double, 1 = Single

Africa Safari Maasai Boma

Pololeti/Serengeti Klein's Gate - North Tanzania
Pololeti Game Reserve - Serengeti National Park

Africa Safari Maasai Boma stands out as truly unique. Situated amidst the stunning landscapes between Lake Natron to the east, Serengeti National Park to the west, and Ngorongoro to the south, its location is unparalleled.

The accommodation itself is a tribute to Maasai culture, featuring Safari Comfort Bungalows designed as traditional Maasai bomas: round mud houses with thatched roofs, offering simplicity, solidity, and comfort. Each bungalow boasts a spacious bedroom decorated with authentic Maasai artifacts and beadwork. Furnished with a king-size bed and a single bed, the room includes an ensuite bathroom with a walk-in shower, toilet, and washbasin. Additionally, there are 5 Maasai Safari huts available, featuring shared toilet and shower facilities.

Just minutes from the village of Ololosokwan and 15 minutes from Serengeti's Klein's Gate, the camp is perfectly positioned for game drives to witness the Great Migration or explore the hidden gems of Pololeti Game Reserve, including ranger-led night drives and bush walks.

- ✓ Breathtaking location
- ✓ The only affordable accommodation in the area
- ✓ Perfect place to stay between Serengeti and Lake Natron
- ✓ Experience the Maasai way of life
- ✓ Close proximity to game parks and national parks
- ✓ Walking safaris & Night game drives possible
- ✓ Swimming pool
- ✓ Complimentary use of pool towels, safety deposit box and Wi-Fi

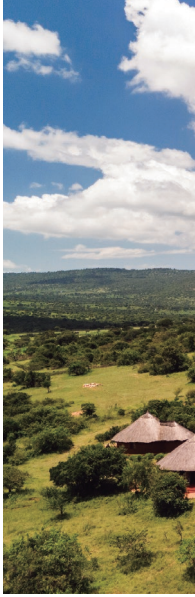

Highlights



15 minutes from Serengeti's Klein's Gate.



Perfect overnight between Lake Natron & Serengeti



Night game drive & walking trails are possible



Located near Pololeti Game Reserve



Traditional Maasai style bungalows and huts



Amazing views with the Kenyan Maasai Mara in the background



Wi-Fi by satellite



Only 1.1 km from the main road



Unique location and affordable



Swimming pool



FAQ

Our staff speak multiple languages

ATM not available. USD, Euro, Shillings & credit cards are welcome

Is it safe? Yes! The lodge is protected by the Maasai tribe

When is the best time to go? All year round! Being situated at a higher altitude, the daytime temperature averages 25°C, with evenings cooling down to around +/-15°C

Check-in: 14.00h / Check-out: 11.00h

Solar heated water and electricity

Plug type: UK (type G)



01/11/2025 - 31/10/2027 based on Full Board meal plan

Rates per night, per person and based on 2 person sharing, Full Board meal plan

AFRICA SAFARI MAASAI BOMA Serengeti Klein's Gate - Ngorongoro district - North Tanzania	1 NOVEMBER - 14 MARCH 16 MAY - 31 OCTOBER	15 MARCH - 15 MAY
	Meal plan: Full Board	
Safari Comfort Bungalow	\$183.00	\$128.00
Safari Comfort Family Bungalow (min 4 guests)	\$183.00	\$128.00
Maasai Safari Hut	\$99.00	\$69.00
Children 0 – 1.99 years (Sharing Room)	-	-
Children 1.99 – 11.99 years (Sharing Room)	\$59.00	\$41.00
Adults > 12 years (Sharing Room)	\$107.00	\$75.00

Meal plan change rates

	HIGH SEASON		LOW SEASON	
	Meal plan change for adults	Half Board -/- \$19.00	Bed & Breakfast -/- \$44.00	Half Board -/- \$13.00
Meal plan change for children	Half Board -/- \$9.00	Bed & Breakfast -/- \$22.00	Half Board -/- \$6.00	Bed & Breakfast -/- \$15.00

TDL² and Village fee³ of US\$2.50 per person per night are not included and must be paid upon check-in. Prices may be adjusted due to unforeseen changes and/or new government levies. All rooms except Safari Comfort Family Bungalow can be used for single occupancy. Single room rate on request, contact us for detailed prices.

ROOM TYPE:	Num. of rooms	Guests per rooms	Bedroom size (sqm)	Bathroom size (sqm)	Balcony size (sqm)	Total room size (sqm)	King size bed	Sofa/ Single bed	Max. guests per room
Safari Comfort Bungalow	10	2+1	32	7	3	42	1	1	3
Safari Comfort Family Bungalow (min 4 guests)	2	2+2+1	65	15	5	85	2	1	5
Maasai Safari Hut	5	1+1							2

Guests per room: 2 = Double, 1 = Single



Africa Safari Serengeti Kogatende

Kogatende - Serengeti National Park
Mara River - North Tanzania

Opening
soon





Africa Safari Serengeti Ikoma

Ikoma - North Tanzania
Ikona Game Controlled Area - Serengeti
National Park

Located within the Serengeti Ecosystem, Africa Safari Serengeti Ikoma provides a comfortable safari experience. The lodge is ideally positioned just 300 meters from the National Park boundary while still being situated within the Game Controlled Area of the Tanzanian Wildlife Authority (TAWA).

Positioned between Serengeti Seronera, Grumeti and Ikorongo Game Reserves the location is perfect for exploring the Serengeti and all that there is to do in one of the country's largest National Parks. Due to its proximity to the Grumeti River, Africa Safari Serengeti Ikoma's has a backyard full of animals and the Great Migration is there several months of the year. Additionally, the Ikona Game Controlled Area has also proven to be a hidden treasure when it comes to wildlife.

- ✓ Overlooking the Serengeti Plains
- ✓ (Night) Game drives and bushwalk in WMA Ikona
- ✓ Located between Serengeti Seronera, Grumeti and Ikorongo Game Reserves
- ✓ The Great Migration
- ✓ Free Wi-Fi in restaurant and bar
- ✓ 24-hrs security
- ✓ Safari jeep with pop-up roof for hire (no self-drive) on request
- ✓ Swimming pool
- ✓ Complimentary use of pool towels and safety deposit box



Highlights



(Night) Game drives and bushwalk in WMA Ikona



Great Migration



Top location between Serengeti, Grumeti & Ikorongo



Perfect overnight to explore Serengeti NP



Experience sleeping under canvas



Great views of Serengeti's endless plains



Wi-Fi by satellite



Only 1,2 kms from the main road



4 Kms from Fort Ikoma entrance gate to the Serengeti NP



Balloon Safari



FAQ

Our staff speak multiple languages

ATM not available. USD, Euro, Shillings & credit cards are welcome

Is it safe? Yes! The lodge is protected by the Maasai tribe

When is the best time to go? All year round! Ikoma and surrounds enjoys a beautiful, mild climate with an average daytime temperature of 30°C

Check-in: 14.00h / Check-out: 11.00h

Solar heated water and electricity

Plug type: UK (type G)



01/11/2025 - 31/10/2027 based on Full Board meal plan

Rates per night, per person and based on 2 person sharing, Full Board meal plan

AFRICA SAFARI SERENGETI IKOMA Serengeti Fort Ikoma Gate - Ikoma - North Tanzania	1 NOVEMBER - 14 MARCH 16 MAY - 31 OCTOBER	15 MARCH - 15 MAY
ROOM TYPE:	Meal plan: Full Board	
Safari Comfort Accommodation	\$152.00	\$106.00
Safari Comfort Family Accommodation (min. 4 guests)	\$152.00	\$106.00
Safari Tent	\$99.00	\$69.00
Children 0 – 1.99 years (Sharing Room)	-	-
Children 1.99 – 11.99 years (Sharing Room)	\$59.00	\$41.00
Adults > 12 years (Sharing Room)	\$107.00	\$75.00

Meal plan change rates

	HIGH SEASON		LOW SEASON	
Meal plan change for adults	Half Board -/- \$19.00	Bed & Breakfast -/- \$44.00	Half Board -/- \$13.00	Bed & Breakfast -/- \$30.00
Meal plan change for children	Half Board -/- \$9.00	Bed & Breakfast -/- \$22.00	Half Board -/- \$6.00	Bed & Breakfast -/- \$15.00

*TDL² and Village fee³ of US\$2.50 per person per night are not included and must be paid upon check-in.
WMA fee⁴ for Tanzania Wildlife Authority is not included and agents must submit these fees electronically online, while for private visitors, Africa Safari Serengeti Ikoma can assist.
Prices may be adjusted due to unforeseen changes and/or new government levies.
All rooms except Safari Comfort Family Accommodation can be used for single occupancy.
Single room rate on request, contact us for detailed prices.*

TAWA's WMA fee, per person per night

	NON-CITIZEN & RESIDENTS (USD)	TANZANIAN CITIZEN (TANZANIAN SHILLINGS)
Aged 18 years and Above	\$29.50	TSH8,260
Aged 5 - 17.99 years	\$23.60	TSH7,080
Aged below 5 years	\$0.00	TSH0

TAWA park fees are based on publication 2022

ROOM TYPE:	Num. of rooms	Guests per rooms	Bedroom size (sqm)	Bathroom size (sqm)	Balcony size (sqm)	Total room size (sqm)	King size bed	Sofa/Single bed	Bunk bed	Add. single bed (on request)	Max. guests per room
Safari Comfort Accommodation	8	1+1	30	10	10	50		2		1	3
	17	2	30	10	10	50	1			1	3
Safari Comfort Family (min 4 guests)	2	2+1+1+1	16+16	5	15	75	1		2		6
Safari Tent	5	1+1									2

2: Double bed 1: single bed

Africa Safari Serengeti Kusini

Kusini Plains - Serengeti National Park

Africa Safari Serengeti Kusini is located in the southern Serengeti National Park, in the corridor of the famous wildebeest migration, offering sightings of all the wildlife you would expect from the Serengeti. The Kusini Plains captivate tourists with its expansive savannahs and rich wildlife diversity. Here, the spectacle of millions of wildebeests and zebras in rhythmic migration unfolds against a golden grasslands backdrop. Beyond the migratory herds, the area hosts an array of resident wildlife, including lions, giraffes, buffalo, and elephants.

The Kusini Crater is not an actual volcanic crater, but rather a circular-shaped grassland surrounded by a forest of acacias. Offering dramatic vistas and lush vegetation, it serves as a haven where diverse wildlife congregates around watering holes visible from the crater's rim. When travelling between Kusini and Ndutu, there is the opportunity to discover the Hidden Valley, a depression and water catchment area teeming with wildlife during the green season. This region, known for its predatory action, often witnesses large clans of spotted hyenas wallowing in the muddy shores.

- ✔ Safari style with luxury comfort
- ✔ Perfectly positioned in the Serengeti National Park
- ✔ Kusini Crater
- ✔ Hidden Valley water catchment
- ✔ On the path of the wildebeest migration
- ✔ European migrant storks
- ✔ Free Wi-Fi in restaurant and bar
- ✔ Electricity on solar energy and generator
- ✔ 24-hrs security
- ✔ Water heated by solar energy
- ✔ Safari jeep with pop-up roof for hire (no self-drive) on request



Highlights



Built in 2024



Home to the Great Migration calving season



Sleeping under canvas



Wi-Fi by satellite



Glamping in the middle of the bush



45 km from Lake Ndutu



Kusini Crater



Abundant bird life



Different possibilities/areas for game drives



Off the beaten track



FAQ

Our staff speak multiple languages

ATM not available. USD, Euro, Shillings & credit cards are welcome

Is it safe? Yes! Follow the camp rules and listen to the rangers

When is the best time to go? All year round! Serengeti enjoys a beautiful, mild climate with an average daytime temperature of 30°C

Check-in: 14.00h / Check-out: 11.00h

Hot water and electricity

Plug type: UK (type G)



01/11/2025 - 31/10/2027 based on Full Board meal plan

Rates per night, per person and based on 2 person sharing, Full Board meal plan

AFRICA SAFARI SERENGETI KUSINI Kusini Plains - Serengeti National Park	1 NOVEMBER - 14 MARCH 16 MAY - 31 OCTOBER	15 MARCH - 15 MAY
ROOM TYPE:	Meal plan: Full Board	
Safari Luxury Glamping	\$255.00	\$179.00
Safari Family Accommodation (min. 4 guests)	\$255.00	\$179.00
Children 0 – 1.99 years (Sharing Room)	-	-
Children 2 – 11.99 years (Sharing Room)	\$90.00	\$63.00
Adults > 12 years (Sharing Room)	\$165.00	\$116.00

Meal plan change rates

	HIGH SEASON		LOW SEASON	
Meal plan change for adults	Half Board -/- \$19.00	Bed & Breakfast -/- \$44.00	Half Board -/- \$13.00	Bed & Breakfast -/- \$30.00
Meal plan change for children	Half Board -/- \$9.00	Bed & Breakfast -/- \$22.00	Half Board -/- \$6.00	Bed & Breakfast -/- \$15.00

TDL² and Village fee³ of US\$2.50 per person per night are not included and must be paid upon check-in. TANAPA TANAPA Concession fee⁴ and park entry fees are not included and agents must submit these fees electronically online, while for private visitors, Africa Safari Serengeti Kusini can assist. Prices may be adjusted due to unforeseen changes and/or new government levies. All rooms except Safari Family accommodation can be used for single occupancy. Single room rate on request, contact us for detailed prices.

TANAPA fee, per person per night

	NON-CITIZEN & RESIDENTS (USD)	TANZANIAN CITIZEN (TANZANIAN SHILLINGS)
Aged 16 years Above	\$70.80	TSH17.700
Aged 5 -15.99 years	\$35.40	TSH8.850
Aged below 5 years	\$0.00	TSH0

TANAPA fees are based on publication 2023.

ROOM TYPE:	Num. of rooms	Guests per rooms	Bedroom size (sqm)	Bathroom size (sqm)	Balcony size (sqm)	Total room size (sqm)	King size bed	Sofa/Single bed	Bunk bed	Add. single bed (on request)	Max. guests per room
Safari Luxury Glamping	25	2+1	30	10	20	60	1	1		1	4
Safari Family Accommodation (min. 4 guests)	2	2+(1+1)+(1+1)	40	10	10	60	1		2		6

2: Double bed | 1: single bed



Africa Safari South Serengeti

Lake Ndutu - North Tanzania
Ngorongoro Conservation Area
Ngorongoro Crater - Serengeti National Park

Africa Safari South Serengeti is perfectly situated within the Ngorongoro Conservation Area, with convenient access to the crater, and on the south side of Lake Ndutu, just outside the Serengeti National Park. This is truly the best of both worlds! This area is famous for the calving season of the Great Migration, an absolute highlight of the annual wildebeest migration. The short rains in November and December create nutrient-rich pastures for the wildebeest, which remain in the vicinity until the end of the long rains and most calves are born in January and February. Whilst the open grassy plains offer them some safety, these young wildebeest attract hungry predators, such as lions, leopards, cheetahs, and hyenas. The area around Lake Ndutu is also famous for being home to 6 species of big cats (lion, cheetah, leopard, serval, African wild cat and caracal) which are present throughout the year. Between April and November, the south-eastern plains dry out, but there is still an abundance of game in the area as there are two important water sources, Lake Masek and Lake Ndutu, where many wild animals come to drink.

- ✓ Free Wi-Fi in restaurant and bar
- ✓ The best location during the Calving Season and the Great Migration
- ✓ Ndutu area is rich in wildlife all year round
- ✓ Sleeping under canvas
- ✓ Located midway between Serengeti NP and Ngorongoro Crater
- ✓ Different possibilities/areas for game drives
- ✓ Home to 6 species of big cats
- ✓ Olduvai Gorge
- ✓ Shifting Sands dunes
- ✓ Seasonal hot air ballooning



Highlights



Located midway between Serengeti NP and Ngorongoro Crater



Various possibilities and areas for game drives



Home to the Great Migration calving season



Sleeping under canvas



Wi-Fi by satellite



Glamping in the middle of the bush



1 km from Lake Ndutu



3 km from Lake Ndutu airstrip



Abundant bird life



Famous area because of researchers Jane Goodall, Hugo van Lawick and Mary Leakey



FAQ

Our staff speak multiple languages

ATM not available. USD, Euro, Shillings & credit cards are welcome

Is it safe? Yes! Follow the camp rules and listen to the rangers

When is the best time to go? All year round! Serengeti enjoys a beautiful, mild climate with an average daytime temperature of 30°C

Check-in: 14.00h / Check-out: 11.00h

Solar heated water and electricity

Plug type: UK (type G)



01/11/2025 - 31/10/2027 based on Full Board meal plan

Rates per night, per person and based on 2 person sharing, Full Board meal plan

AFRICA SAFARI SOUTH SERENGETI Lake Ndutu - Endulen - Ngorongoro Conservation Area - North Tanzania	1 NOVEMBER - 14 MARCH 16 MAY - 31 OCTOBER	15 MARCH - 15 MAY
ROOM TYPE:	Meal plan: Full-board	
Safari Comfort Accommodation	\$191.00	\$134.00
Safari Comfort Family (min 4 guests)	\$191.00	\$134.00
Safari Luxury Glamping	\$223.00	\$156.00
Safari Tent	\$126.00	\$88.00
Children 0 – 1.99 years (Sharing Room)	-	-
Children 1.99 – 11.99 years (Sharing Room)	\$90.00	\$63.00
Adults > 12 years (Sharing Room)	\$165.00	\$116.00

Peak season surcharge per person per night: 1st January - 14th March

Children 0 - 1.99 years	-
Children 1.99 - 11.99 years	\$10.00
Adults >12 years	\$20.00

Meal plan change rates

	HIGH SEASON		LOW SEASON	
Meal plan change for adults	Half Board -/-\$19.00	Bed & Breakfast -/-\$44.00	Half Board -/-\$13.00	Bed & Breakfast -/-\$30.00
Meal plan change for children	Half Board -/-\$9.00	Bed & Breakfast -/-\$22.00	Half Board -/-\$6.00	Bed & Breakfast -/-\$15.00

TDL² and Village fee³ of US\$2.50 per person per night are not included and must be paid upon check-in.
Ngorongoro Concession fee⁶ and park entry fees are not included and agents must submit these fees electronically online, while for private visitors, Africa Safari South Serengeti can assist.

Prices may be adjusted due to unforeseen changes and/or new government levies.

All rooms except Safari Comfort Family Accommodation can be used for single occupancy.
Single room rate on request, contact us for detailed prices.

Ngorongoro Conservation Area Concession fee - per person per night

	NON-CITIZEN & RESIDENTS (USD)	TANZANIAN CITIZEN (TANZANIAN SHILLINGS)
Aged 16 years and Above	\$70.80	TSH17.700
Aged 5 - 15.99 years	\$35.40	TSH8.850
Aged below 5 years	\$0.00	TSH0

ROOM TYPE:	Num. of rooms	Guests per rooms	Bedroom size (sqm)	Bathroom size (sqm)	Balcony size (sqm)	Total room size (sqm)	King size bed	Sofa/Single bed	Bunk bed	Add. single bed (on request)	Max. guests per room
Safari Comfort Accommodation	20	2	28	4	8	40	1			1	3
Safari Comfort Family (min. 4 guests)	2	2+(1+1)+(1+1)	44	6	10	60	1		2		6
Safari Luxury Glamping	6	2+1	44	6	10	60	1	1		1	4
Safari Tent	5	1+1									2

Guests per room: 2 = Double | 1 = Single



Africa Safari Ngorongoro Crater

Opening
soon





Africa Safari Karatu

Karatu - North Tanzania Lake Manyara National Park - Ngorongoro Crater

Africa Safari Karatu is a luxury safari lodge located on the edge of the Ngorongoro Conservation Area. The area became popular with early settlers and farmers because of its cool climate, green hills, and beautiful views, with coffee being one of the most important crops. The rolling slopes of the extinct Ol Deani volcano are a striking feature of the landscape. The accommodation is located on top of a hill and offers a stunning view of the Northern Highlands, Lake Eyasi, and its surroundings. Due to the ideal location, Lake Manyara National Park and the world-famous Ngorongoro Crater are easily accessible.

Africa Safari Karatu offers two types of accommodation; Safari Comfort Bungalows and Safari Luxury Bungalows, all with air-conditioning and offering you all the luxury you wish for before or after your safari! As the property is built on an elevation, not only do the bar, restaurant, and swimming pool boast amazing vistas but each bungalow has its own balcony with 180-degree views across the endless landscape.

NEW
All rooms have air-conditioning

- ✓ Breathtaking landscapes and scenery
- ✓ Close to the Ngorongoro Crater and Lake Manyara National Park
- ✓ Perfect stop-over between Arusha and Serengeti
- ✓ 1 hour drive to Africa Safari Lake Manyara
- ✓ 2 hour drive to Africa Safari South Serengeti
- ✓ Great facilities
- ✓ Various day activities available
- ✓ Swimming pool
- ✓ Free Wi-Fi in restaurant and bar
- ✓ 24-hrs security
- ✓ Complimentary use of pool towels and safety deposit box



Highlights



Views of the Northern Highlands



Perfect overnight between Lake Manyara and the Ngorongoro Crater



Wi-Fi by satellite



Swimming pool



Unique location and affordable



Only 10km from the Ngorongoro Gate



Located in the centre of the Northern Safari Circuit



Nicely decorated bungalows with brick wall design



Restaurant with a great view



Variety of activities



FAQ

Our staff speak multiple languages

ATM is available in Karatu

USD, Euro, Shillings & credit cards are welcome

Is it safe? Yes! Follow the camp rules and listen to the rangers

When is the best time to go? All year round!

Check-in: 14.00h / Check-out: 11.00h

Hot water and electricity

Plug type: UK (type G)



This location is free of wildlife area entrance and concession fees

01/11/2025 - 31/10/2027 based on Full Board meal plan

Rates per night, per person and based on 2 person sharing, Full Board meal plan

AFRICA SAFARI KARATU Karatu - North Tanzania Lake Manyara National Park - Ngorongoro Crater	1 NOVEMBER - 14 MARCH 16 MAY - 31 OCTOBER	15 MARCH - 15 MAY
ROOM TYPE:	Meal plan: Full Board	
Safari Comfort Bungalow	\$126.00	\$88.00
Safari Luxury Bungalow	\$152.00	\$106.00
Safari Tent	\$99.00	\$69.00
Children 0 – 1.99 years (Sharing Room)	-	-
Children 1.99 – 11.99 years (Sharing Room)	\$56.00	\$39.00
Adults > 12 years (Sharing Room)	\$95.00	\$67.00

Meal plan change rates

	HIGH SEASON		LOW SEASON	
Meal plan change for adults	Half Board -/- \$19.00	Bed & Breakfast -/- \$44.00	Half Board -/- \$13.00	Bed & Breakfast -/- \$30.00
Meal plan change for children	Half Board -/- \$9.00	Bed & Breakfast -/- \$22.00	Half Board -/- \$6.00	Bed & Breakfast -/- \$15.00

TDL² and Village fee³ of US\$2.50 per person per night are not included and must be paid upon check-in.

Prices may be adjusted due to unforeseen changes and/or new government levies.

All rooms can be used for single occupancy. Single room rate on request, contact us for detailed prices.

ROOM TYPE:	Num. of rooms	Guests per rooms	Bedroom size (sqm)	Bathroom size (sqm)	Balcony size (sqm)	Total room size (sqm)	King size bed	Sofa/Single bed	Max. guests per room
Safari Comfort Bungalow	42	2+1	34	8	8	50	1	1	3
Safari Luxury Bungalow	28	2+2	42	10	8	60	1	2	4
Safari Tent	5	1+1							2

6 x 2 rooms can be interconnected, offering a great alternative for family accommodations.

2: Double bed | 1: single bed



Africa Safari Escarpment
Lake Manyara

Opening
soon





Africa Safari Migombani
Lake Manyara

Opening
soon





Africa Safari Lake Manyara

Mto wa Mbu - North Tanzania
Lake Manyara National Park - Tarangire National Park - Ngorongoro Crater

Lying between the foothills of Ngorongoro Crater and Lake Manyara, Africa Safari Lake Manyara allows you to explore some of the best safari regions in Tanzania. This unique location makes it the perfect base for visiting the Serengeti, Ngorongoro Crater, Tarangire National Park, Arusha National Park, Lake Manyara National Park, Lake Eyasi, and Lake Natron.

The lodge is built on a handmade island, placed as close to the lake as possible, offering stunning views and a dynamic experience as the water levels change with the seasons. There is always something special to see, as the landscape evolves. Located inside a wildlife park, the property charges a park fee, but guests are immersed in real wildlife—hippos can be spotted walking around at night, while zebras, wildebeests, and many other animals roam during the day.

The accommodation consists of premium bungalows, available in one- or two-room configurations, offering all the comforts of a luxury retreat. These bungalows feature a raised wooden deck with spectacular views, ensuring an unforgettable stay surrounded by nature.

A dip in the swimming pool is refreshing after a day of exploring, or retreat to the spa for a relaxing treatment. Whether you're seeking adventure or relaxation, Africa Safari Lake Manyara offers a truly exceptional experience.

Lodge Closed for Upgrades. Reopening 1 July 2026

- ✓ Wildlife such as zebras & wildebeest sometimes present in/around the camp
- ✓ On the shores of Lake Manyara
- ✓ Short drive from Arusha
- ✓ Swimming pool
- ✓ Suitable for long stays
- ✓ Perfect for birders
- ✓ Top location as a base for visits to Ngorongoro Crater, Lake Manyara N.P and Tarangire N.P.
- ✓ Free Wi-Fi in restaurant and bar
- ✓ 24-hrs security
- ✓ Safari jeep with pop-up roof for hire (no self-drive) on request

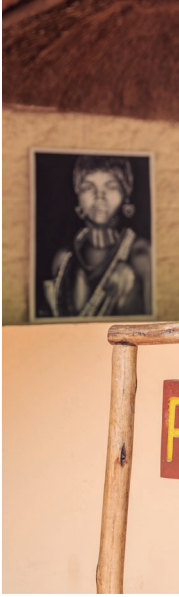

Highlights



Located in the best safari region of Tanzania



Activities allowed in the Game Controlled Area



Near to Lake Manyara airstrip



Ngorongoro Crater, Lake Manyara NP and Tarangire NP



Safari style with luxury comfort



Wildlife such as zebras and wildebeests walking around the camp



Wi-Fi by satellite



Only 3.3 Km from the main road, on the shore of Lake Manyara



Unique location and affordable



Swimming pool



FAQ

Our staff speak multiple languages
ATM is available in Mto Mwa Mbu (15 minutes drive away)

USD, Euro, Shillings & credit cards are welcome
Daily flights available to Arusha or Lake Manyara airstrip

Is it safe? Yes! Follow the camp rules and listen to the rangers

When is the best time to go? All year round!
Lake Manyara enjoys a beautiful climate with an average daytime temperature of 30°C

Check-in: 14.00h / Check-out: 11.00h

Solar heated water and electricity

Plug type: UK (type G)



01/11/2025 - 31/10/2027 based on Full Board meal plan

Rates per night, per person and based on 2 person sharing, Full Board meal plan

AFRICA SAFARI LAKE MANYARA Lake Manyara - North Tanzania	1 NOVEMBER - 14 MARCH 16 MAY - 31 OCTOBER	15 MARCH - 15 MAY
ROOM TYPE:	Meal plan: Full Board	
Premium Bungalow	\$200.00	\$140.00
Children 0 – 1.99 years (Sharing Room)	-	-
Children 1.99 – 11.99 years (Sharing Room)	\$59.00	\$41.00
Adults > 12 years (Sharing Room)	\$107.00	\$75.00

Meal plan change rates

	HIGH SEASON		LOW SEASON	
Meal plan change for adults	Half Board -/- \$19.00	Bed & Breakfast -/- \$44.00	Half Board -/- \$13.00	Bed & Breakfast -/- \$30.00
Meal plan change for children	Half Board -/- \$9.00	Bed & Breakfast -/- \$22.00	Half Board -/- \$6.00	Bed & Breakfast -/- \$15.00

TDL² and Village fee³ of US\$2.50 per person per night are not included and must be paid upon check-in.
WMA fee⁴ for Tanzania Wildlife Authority is not included and agents must submit these fees electronically online, while for private visitors, Africa Safari Lake Manyara can assist.
Prices may be adjusted due to unforeseen changes and/or new government levies.
All rooms can be used for single occupancy.
Single room rate on request, contact us for detailed prices.

TAWA's WMA fee, per person per night

	NON-CITIZEN & RESIDENTS (USD)	TANZANIAN CITIZEN (TANZANIAN SHILLINGS)
Aged 18 years and Above	\$29.50	TSH8.260
Aged 5 -17.99 years	\$23.60	TSH7.080
Aged below 5 years	\$0.00	TSH0

TAWA/TANAPA park fees are based on publication 2022

ROOM TYPE:	Num. of rooms	Guests per rooms	Bedroom size (sqm)	Bathroom size (sqm)	Balcony size (sqm)	Total room size (sqm)	King size bed	Sofa/Single bed	Bunk bed	Add. single bed (on request)	Max. guests per room
Premium Bungalow	15	2	30	5	15	50	1				2
	5	2+1+1+1+1	16+16	5	15	75	1		2		6

Guests per room: 2 = Double, 1 = Single

Africa Safari Rift Valley

South West Lake Manyara Lake Manyara National Park - Tarangire National Park The Great Rift Valley

Africa Safari Rift Valley is located in the village of Mayoka, south of Lake Manyara, surrounded by the famous Great Rift Valley. Conveniently located between Tarangire and Lake Manyara, this is the perfect location for relaxation before or after visiting Tanzania's northern National Parks.

Safari Luxury Glamping accommodations feature a raised tiled deck and all the desired luxuries inside, including air-conditioning and ensuite bathroom. This room category also features an outdoor shower, providing the unique opportunity to shower under the open sky surrounded by the sights and sounds of the wilderness. There are also 5 Safari Tents available, with shared toilet and shower facilities.

The swimming pool and restaurant are embedded in the surrounding landscape offering a beautiful view of the Rift Valley and Lake Manyara.

- ✓ Breathtaking views of the Great Rift Valley & Lake Manyara
- ✓ Off-the-beaten track, secluded & quiet
- ✓ Perfectly located between the national parks and is easily accessible
- ✓ Open all year round
- ✓ Swimming pool
- ✓ Free Wi-Fi in restaurant and bar
- ✓ 24-hrs security
- ✓ Safari jeep with pop-up roof for hire (no self-drive) on request
- ✓ Complimentary use of pool towels and safety deposit box



Highlights



Uniquely designed tents



Off the beaten track



Affordable accommodation in an exceptional location



Close to Lake Manyara National Park & Tarangire National Park



Within easy driving distance of Arusha



Swimming pool



Located in a very peaceful and quiet area



Wi-Fi by satellite



Luxury rooms have an outdoor shower under the sun, moon and starry sky



The Great Rift Valley in your front and backyard



Built in 2024



FAQ

Our staff speak multiple languages
ATM not available. USD, Euro, Shillings & credit cards are welcome
Is it safe? Yes! Follow the camp rules and listen to the rangers

When is the best time to go? All year round! The Rift Valley enjoys a beautiful, mild climate with an average daytime temperature of 30°C

Check-in: 14.00h / Check-out: 11.00h
Hot water and electricity
Plug type: UK (type G)



This location is free of wildlife area entrance and concession fees

01/11/2025 - 31/10/2027 based on Full Board meal plan

Rates per night, per person and based on 2 person sharing, Full Board meal plan

AFRICA SAFARI RIFT VALLEY South West Lake Manyara - North Tanzania	1 NOVEMBER - 14 MARCH 16 MAY - 31 OCTOBER	15 MARCH - 15 MAY
ROOM TYPE:	Meal plan: Full Board	
Safari Luxury Glamping	\$191.00	\$134.00
Safari Tent	\$99.00	\$69.00
Children 0 – 1.99 years (Sharing Room)	-	-
Children 2 – 11.99 years (Sharing Room)	\$59.00	\$41.00
Adults > 12 years (Sharing Room)	\$107.00	\$75.00

TDL² and Village fee³ of US\$2.50 per person per night are not included and must be paid upon check-in.
Prices may be adjusted due to unforeseen changes and/or new government levies.
All rooms can be used for single occupancy.
Single room rate on request, contact us for detailed prices.

Meal plan change rates

	HIGH SEASON		LOW SEASON	
Meal plan change for adults	Half Board -/- \$19.00	Bed & Breakfast -/- \$44.00	Half Board -/- \$13.00	Bed & Breakfast -/- \$30.00
Meal plan change for children	Half Board -/- \$9.00	Bed & Breakfast -/- \$22.00	Half Board -/- \$6.00	Bed & Breakfast -/- \$15.00

ROOM TYPE:	Num. of rooms	Guests per rooms	Bedroom size (sqm)	Bathroom size (sqm)	Balcony size (sqm)	Total room size (sqm)	King size bed	Sofa/Single bed	Add. single bed (on request)	Max. guests per room
Safari Luxury Glamping	16	2+1	60	20	20	100	1	1	1	4
Safari Tent	5	1+1								2

2: Double bed 1: single bed



Africa Safari Tarangire

Opening
soon





Africa Safari Kilimanjaro

Halfway between Arusha & Moshi – Tanzania

Opening
soon





Africa Safari Saadani

Saadani National Park - Tanzania

Positioned at the edge of Saadani National Park, Africa Safari Saadani offers the ultimate blend of bush and beach retreat. This beautiful lodge allows guests to revel in the pristine coastal landscape, with the stunning backdrop of a wildlife sanctuary, combining wild encounters with serene relaxation.

Saadani National Park is a unique environment offering plenty of marine life, as well as an abundance of animals. You will have the opportunity to experience a game drive in the morning or afternoon and enjoy the rest of your day on the unspoiled beach, where it is not uncommon to encounter wildlife enjoying the cool breeze as well.

10 Stylish yet casual bungalows, including 2 specifically designed for families, all boast ocean-facing views, locally crafted furniture, and amenities such as air-conditioning, ensuite bathrooms, and private pools.

- ✓ Boutique lodge
- ✓ Air-conditioned bungalows
- ✓ Private plunge pools & rooftop terraces
- ✓ Beach and Bush Holiday
- ✓ Easily accessible from Zanzibar
- ✓ Perfect for bird watchers
- ✓ Witness marine life and animals
- ✓ See the rare Black and white Colobus monkeys
- ✓ Breeding site for endangered Green Turtles
- ✓ Variety of activities available



Highlights



Ocean front bungalows



Private plunge pools



Beach & Bush Holiday



Lunch served in the bush while on game drives



Amazing scenery



All rooms have air-conditioning



Witness marine life and animals



Swimming Pool



Spa & Wellness



Bordering the NP



FAQ

Our staff speak multiple languages

ATM not available. USD, Euro, Shillings & credit cards are welcome

Daily domestic flights and boat connections from Zanzibar

Is it safe? Yes! Follow the camp rules and listen to the rangers

When is the best time to go? All year round! Saadani enjoys a beautiful climate with an average daytime temperature of 30°C

Check-in: 14.00h / Check-out: 11.00h

Solar heated water and electricity

Plug type: UK (type G)



01/11/2025 - 31/10/2027 based on Full Board meal plan

Rates per night, per person and based on 2 person sharing, Full board meal plan

AFRICA SAFARI SAADANI Saadani Game Reserve - Tanzania	1 NOVEMBER - 14 MARCH 16 MAY - 31 OCTOBER	15 MARCH - 15 MAY
	Meal plan: Full board	Meal plan: Full board
Luxury Bungalow / Air-conditioned	\$250.00	\$175.00
Premium Bungalow / Air-conditioned	\$300.00	\$210.00
Children 0 – 1.99 years (Sharing Room)	-	-
Children 1.99 – 11.99 years (Sharing Room)	\$75.00	\$52.00
Adults > 12 years (Sharing Room)	\$125.00	\$87.50

Meal plan change rates

	HIGH SEASON		LOW SEASON	
	Meal plan change for adults	Half Board -/- \$19.00	Bed & Breakfast -/- \$44.00	Half Board -/- \$13.00
Meal plan change for children	Half Board -/- \$9.00	Bed & Breakfast -/- \$22.00	Half Board -/- \$6.00	Bed & Breakfast -/- \$15.00

TDL² and Village fee³ of US\$2.50 per person per night are not included and must be paid upon check-in.
Prices may be adjusted due to unforeseen changes and/or new government levies.
All rooms except Premium Bungalows can be used for single occupancy.
Single room rate on request, contact us for detailed prices.

ROOM TYPE:	Num. of rooms	Guests per rooms	Bedroom 1 size (sqm)	Bedroom 2 size (sqm)	Bathroom 1 size (sqm)	Bathroom 2 size (sqm)	Living room size (sqm)	Terrace size (sqm)	Plunge Pool incorp. into terrace (sqm)	Total room size (sqm)	King size bed	Sofa/ Single bed	Sofa/ Double bed	Max. guests per room
Luxury Bungalow	10	2+1	24		8			16	6	48	1	1		3
Premium Bungalow	3	2+1+1+2	12	15	6	8	24	22	8	95	1	2	1	6

In 2026, the room count will include 20 Luxury Bungalows and 5 Premium Bungalows.

2: Double bed | 1: single bed

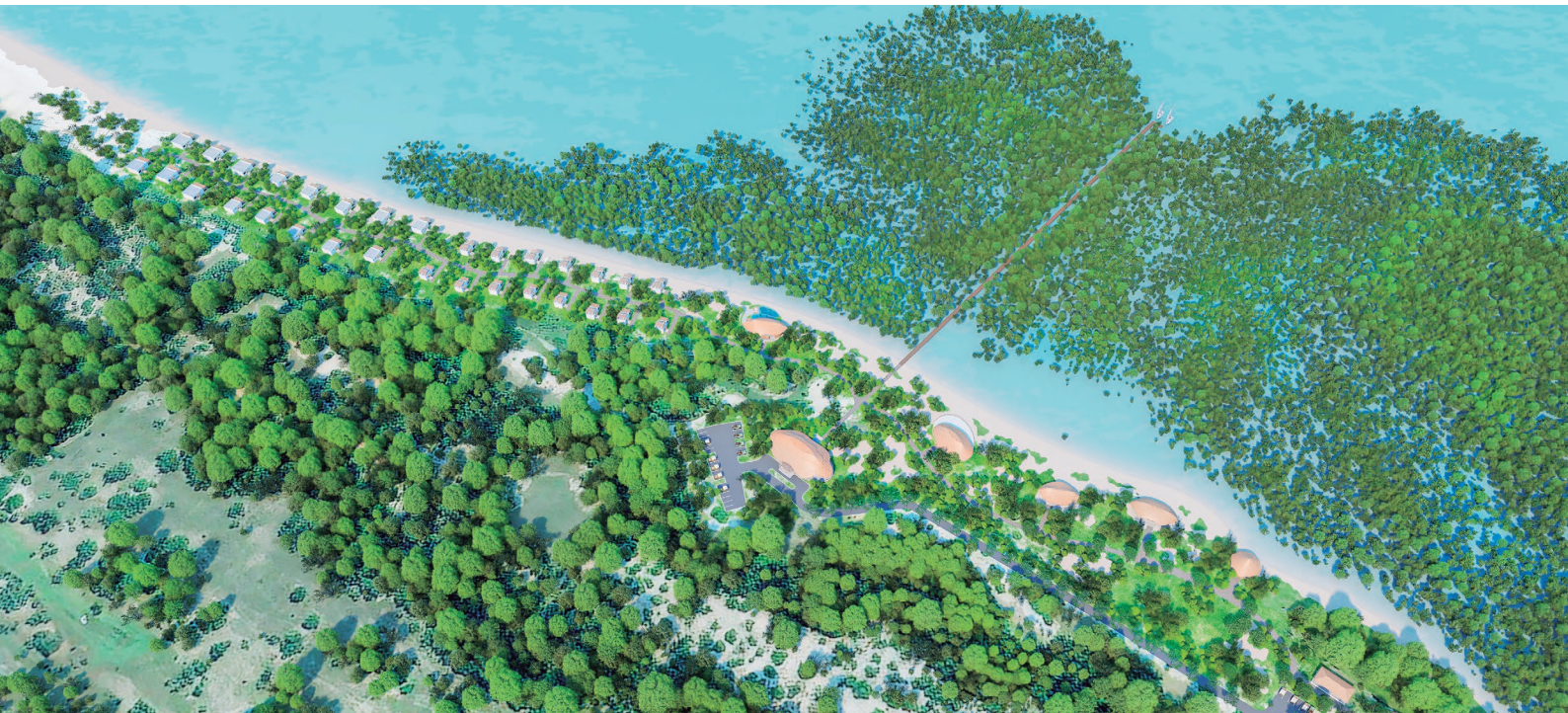

Africa Safari Selous

Selous G.R./Nyerere National Park - Tanzania

Africa Safari Selous is more than just a lodge. A stay here is an unrivalled safari experience that you are unlikely to find anywhere else. Located just outside the Selous Game Reserve/Nyerere National Park in southern Tanzania, the property is spacious and much of the original vegetation has been retained, with respect for the environment reflected in each of the carefully constructed rooms. The restaurant overlooks a waterhole, a perfect place for you to enjoy a delicious meal whilst waiting for some of the animals to pass by for a drink. Africa Safari Selous caters for every budget, ranging from pre-built Safari tents to Banda Bungalows and Pool Bungalows.

- ✓ Pool Bungalows with air-conditioning
- ✓ Perfect place to stay to explore Selous Game Reserve/Nyerere National Park
- ✓ Great facilities
- ✓ Close to the famous Rufiji River
- ✓ Short drive from Mtemere airstrip/Gate
- ✓ Swimming pools
- ✓ Only 30 minutes flight from Zanzibar
- ✓ Free Wi-Fi in restaurant and bar
- ✓ Complimentary use of pool towels and safety deposit box
- ✓ Boutique store

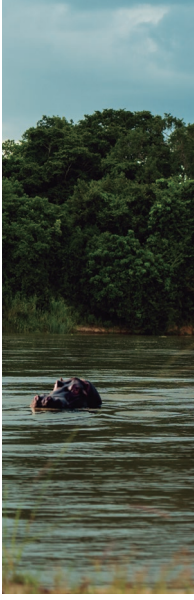

Highlights



Remote and extensive wildlife area for the best safari experience



Daily, direct Zanzibar flights, early morning and late afternoon



Bush walks & boat safaris



Perfect location for various game drives in the park



Pool bungalows with AC



Outside lounge area with campfire



Wi-Fi by satellite



Located close to the Mtemere airstrip/gate



Real bush location, close to the Rufiji River



Swimming pools



FAQ

Our staff speak multiple languages

ATM not available. USD, Euro, Shillings & credit cards are welcome

Daily domestic flights from Zanzibar and Dar es Salaam, new 201km tarmac/murram road from Dar es Salaam

Is it safe? Yes! Follow the camp rules and listen to the rangers

When is the best time to go? All year round! Selous enjoys a beautiful climate with an average daytime temperature of 30°C

Check-in: 14.00h / Check-out: 11.00h

Solar heated water and electricity

Plug type: UK (type G)



This location is free of wildlife area entrance and concession fees

01/11/2025 - 31/10/2027 based on Full Board meal plan

Rates per night, per person and based on 2 person sharing, Full Board meal plan

AFRICA SAFARI SELOUS Selous GR / Nyerere NP - South Tanzania	1 NOVEMBER - 14 MARCH 16 MAY - 31 OCTOBER	15 MARCH - 15 MAY
ROOM TYPE:	Meal plan: Full Board	
Banda Bungalow	\$139.00	\$97.00
Pool Bungalow / Air-conditioned	\$191.00	\$134.00
Safari Tent	\$99.00	\$69.00
Children 0 – 1.99 years (Sharing Room)	-	-
Children 1.99 – 11.99 years (Sharing Room)	\$55.00	\$39.00
Adults > 12 years (Sharing Room)	\$95.00	\$67.00

Meal plan change rates

	HIGH SEASON		LOW SEASON	
Meal plan change for adults	Half Board -/- \$19.00	Bed & Breakfast -/- \$44.00	Half Board -/- \$13.00	Bed & Breakfast -/- \$30.00
Meal plan change for children	Half Board -/- \$9.00	Bed & Breakfast -/- \$22.00	Half Board -/- \$6.00	Bed & Breakfast -/- \$15.00

TDL² and Village fee³ of US\$2.50 per person per night are not included and must be paid upon check-in. Prices may be adjusted due to unforeseen changes and/or new government levies. All rooms can be used for single occupancy. Single room rate on request, contact us for detailed prices.

ROOM TYPE:	Num. of rooms	Guests per rooms	Bedroom size (sqm)	Bathroom size (sqm)	Balcony size (sqm)	Total room size (sqm)	King size bed	Sofa/ Single bed	Bunk bed	Add. single bed (on request)	Max. guests per room
Banda Bungalow	42	2+1	49	6	6	61	1	1		1	4
Pool Bungalow / Air-conditioned	3	2+1+1+1+1	55	9	6	70	1		2		6
	3	2+1+1	55	9	6	70	1		1		4
Safari Tent	2	1+1									2

Guests per room: 2 = Double, 1 = Single



Africa Safari Nyerere

Selous G.R./Nyerere National Park - Tanzania

Nestled on the border of Selous Game Reserve/Nyerere National Park in Southern Tanzania, Africa Safari Nyerere is a boutique safari lodge providing a tranquil retreat in the heart of Africa's wilderness. Located just outside the National Park, near the renowned Rufiji River, the lodge is easily accessible by both road and air.

With 13 thoughtfully designed bungalows, including 3 tailored for families, each retreat boasts a private pool and rooftop terrace, providing unparalleled views of the surrounding landscape. When you're not out on safari or relaxing in your spacious bungalow, the lodge has a restaurant, bar, swimming pool and a Spa. Africa Safari Nyerere is the perfect retreat after your day's safari adventures.

- ✓ Boutique lodge
- ✓ Air-conditioned bungalows
- ✓ Private plunge pools & rooftop terraces
- ✓ Perfect place to stay to explore Selous Game Reserve/Nyerere NP
- ✓ Great facilities
- ✓ Close to the famous Rufiji River
- ✓ Short drive from Mtemere airstrip / Gate
- ✓ Swimming pool
- ✓ Only 30 minutes flight from Zanzibar
- ✓ Complimentary use of pool towels, safety deposit box and Wi-Fi

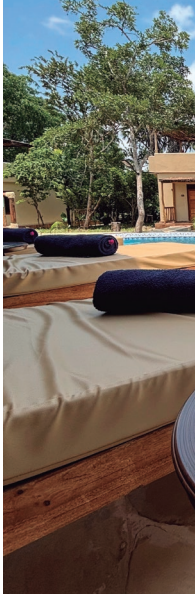

Safari Jeep
Land Cruisers
Available!

Highlights



Boutique bush lodge



Private plunge pools



Daily, direct Zanzibar flights, early morning and late afternoon



Swimming pool



All rooms have air-conditioning



Variety of activities available



Free Wi-Fi



Spa & Wellness



Boat safaris



Bordering the NP



FAQ

Our staff speak multiple languages

ATM not available. USD, Euro, Shillings & credit cards are welcome

Daily domestic flights from Zanzibar and Dar es Salaam, new 201km tarmac/ murrum road from Dar es Salaam

Is it safe? Yes! Follow the camp rules and listen to the rangers

When is the best time to go? All year round! Selous enjoys a beautiful climate with an average daytime temperature of 30°C

Check-in: 14.00h / Check-out: 11.00h

Solar heated water and electricity

Plug type: UK (type G)



This location is free of wildlife area entrance and concession fees

01/11/2025 - 31/10/2027 based on Premium All-inclusive meal plan

Rates per night, per person and based on 2 person sharing, Premium All-inclusive meal plan

AFRICA SAFARI NYERERE Selous GR / Nyerere NP - South Tanzania	1 NOVEMBER - 14 MARCH 16 MAY - 31 OCTOBER	15 MARCH - 15 MAY
ROOM TYPE:	Meal plan: All-inclusive	
Luxury Bungalow / Air-conditioned	\$275.00	\$193.00
Premium Bungalow / Air-conditioned	\$325.00	\$228.00
Children 0 – 1.99 years (Sharing Room)	-	-
Children 1.99 – 11.99 years (Sharing Room)	\$100.00	\$70.00
Adults > 12 years (Sharing Room)	\$150.00	\$105.00

TDL² and Village fee² of US\$2.50 per person per night are not included and must be paid upon check-in. Prices may be adjusted due to unforeseen changes and/or new government levies. All rooms except Premium Bungalows can be used for single occupancy. Single room rate on request, contact us for detailed price.

ROOM TYPE:	Num. of rooms	Guests per rooms	Bedroom 1 size (sqm)	Bedroom 2 size (sqm)	Bathroom 1 size (sqm)	Bathroom 2 size (sqm)	Living room size (sqm)	Balcony size (sqm)	Private Pool size (sqm)	Total room size (sqm)	King size bed	Sofa/ Single bed	Sofa/ Double bed	Max. guests per room
Luxury Bungalow / Air-conditioned	20	2+1	24		8			16	6	48	1	1		3
Premium Bungalow / Air-conditioned	5	2+1+1+2	12	15	6	8	24	22	8	95	1	2	1	6

2: Double bed | 1: single bed



Africa Safari/Tagalala Hot Spring

Selous Game Reserve / Nyerere National Park

Opening
soon







We will create with you
a memory for life.





**“Live life with no excuses,
travel with no regrets”**

www.beachsafari.com
info@beachsafari.com

 **+255 699 065 829**

Version

17/2/25

For more contact:

